

Configurable Air Preparation Units

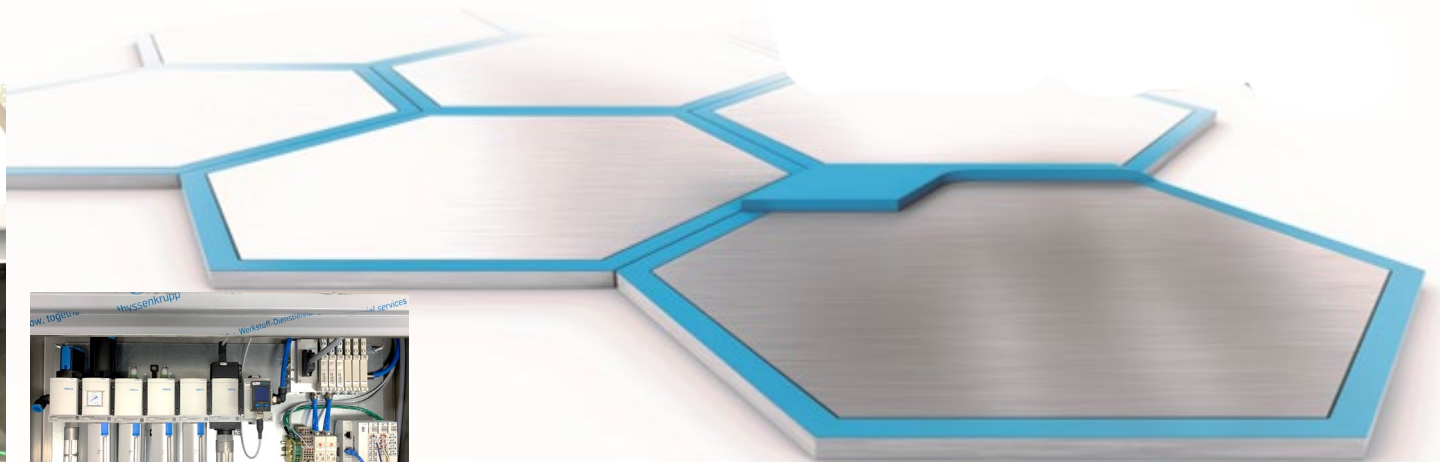

Customer Solution

Industry segments

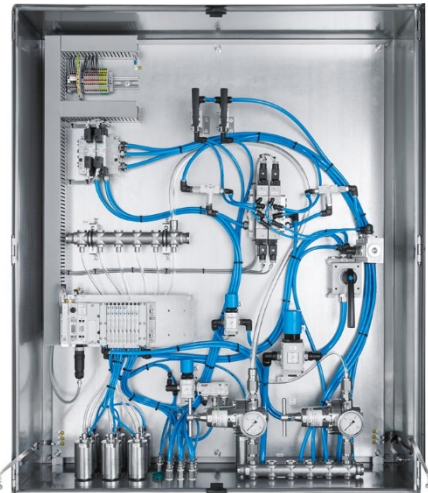
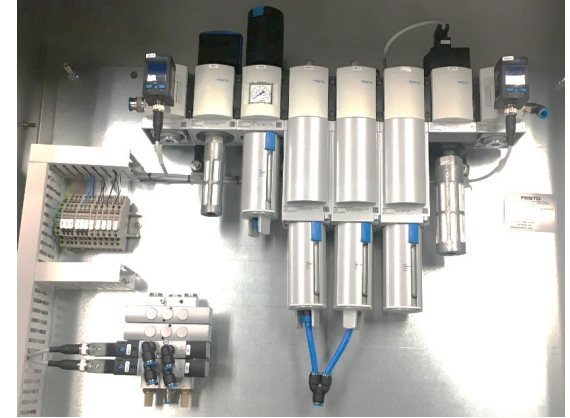
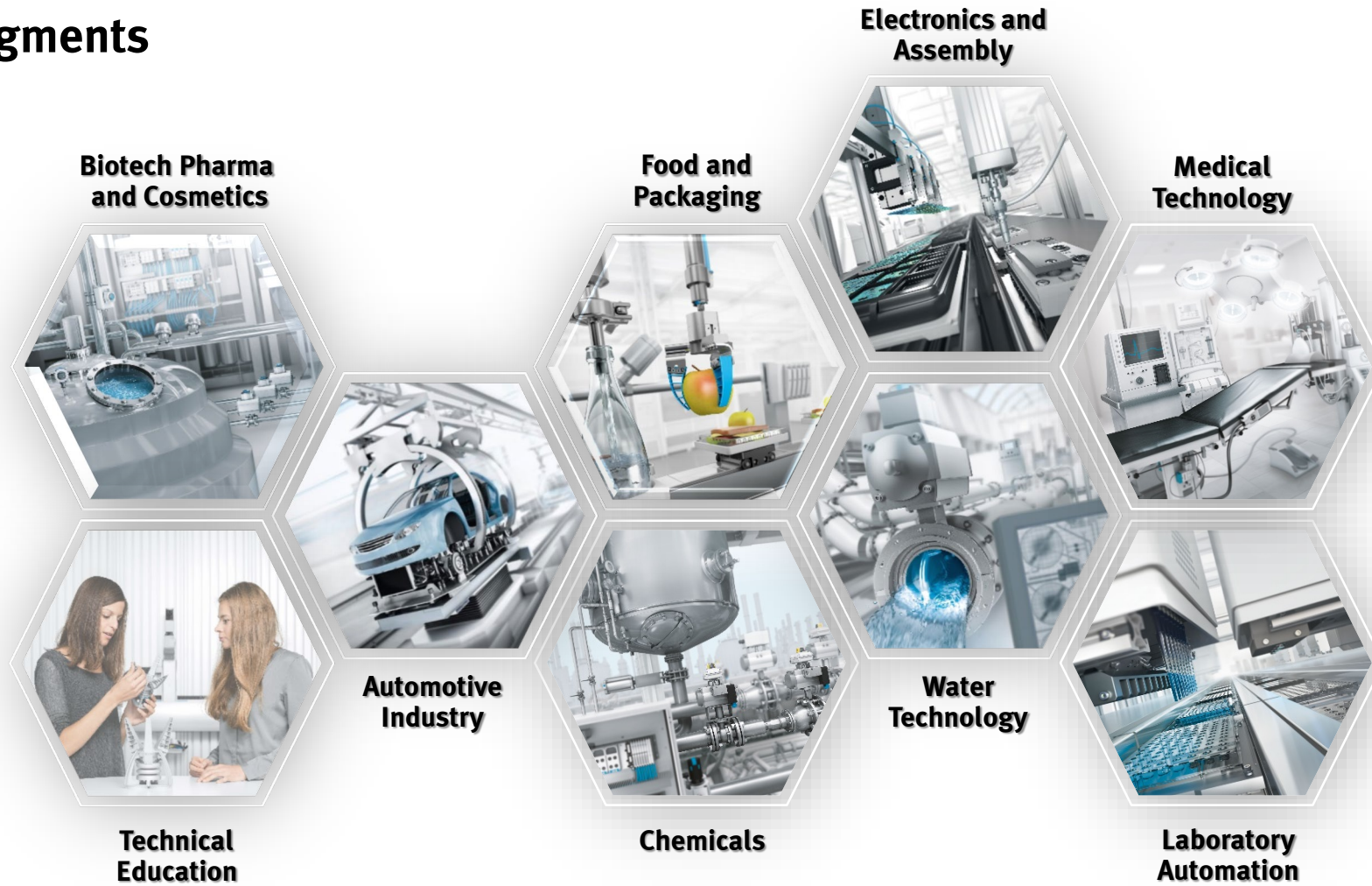

Risk estimation

To calculate the performance level required (PL_r).

S Severity of injury

S1 slight (normally reversible injury)

S2 serious (normally irreversible injury or death)

F Frequency and/or exposure to hazard

F1 seldom to less often and/or exposure time is short

F2 frequent to continuous and/or exposure time is long

P Possibility of avoiding hazard or limiting harm

P1 possible under specific conditions

P2 scarcely possible

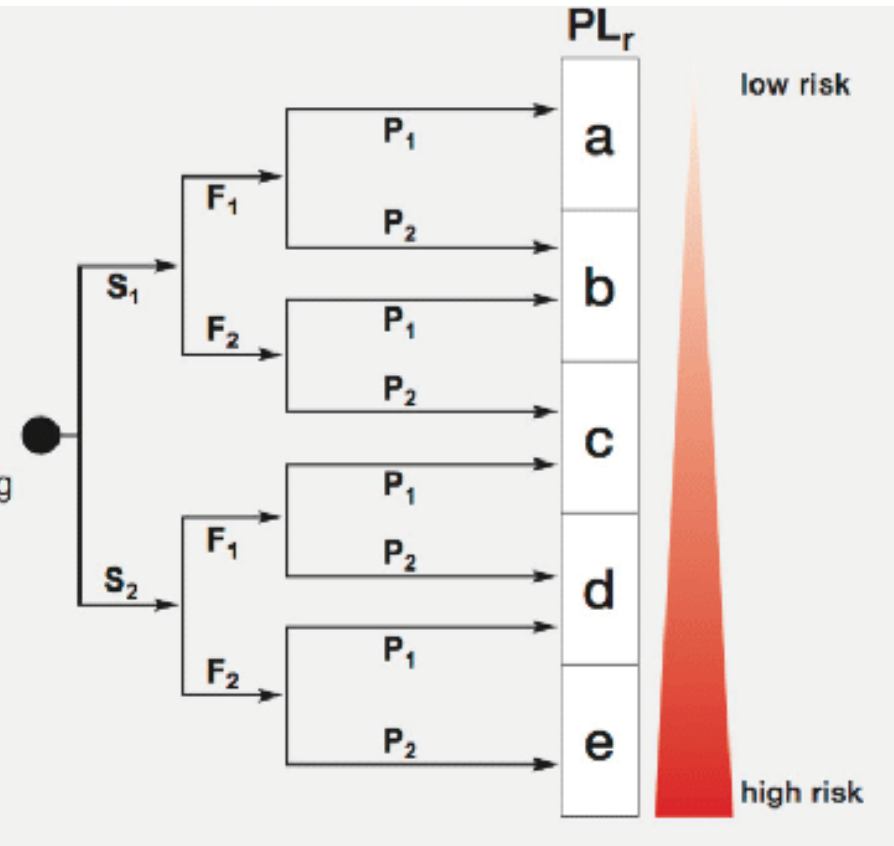

What is a risk estimation?

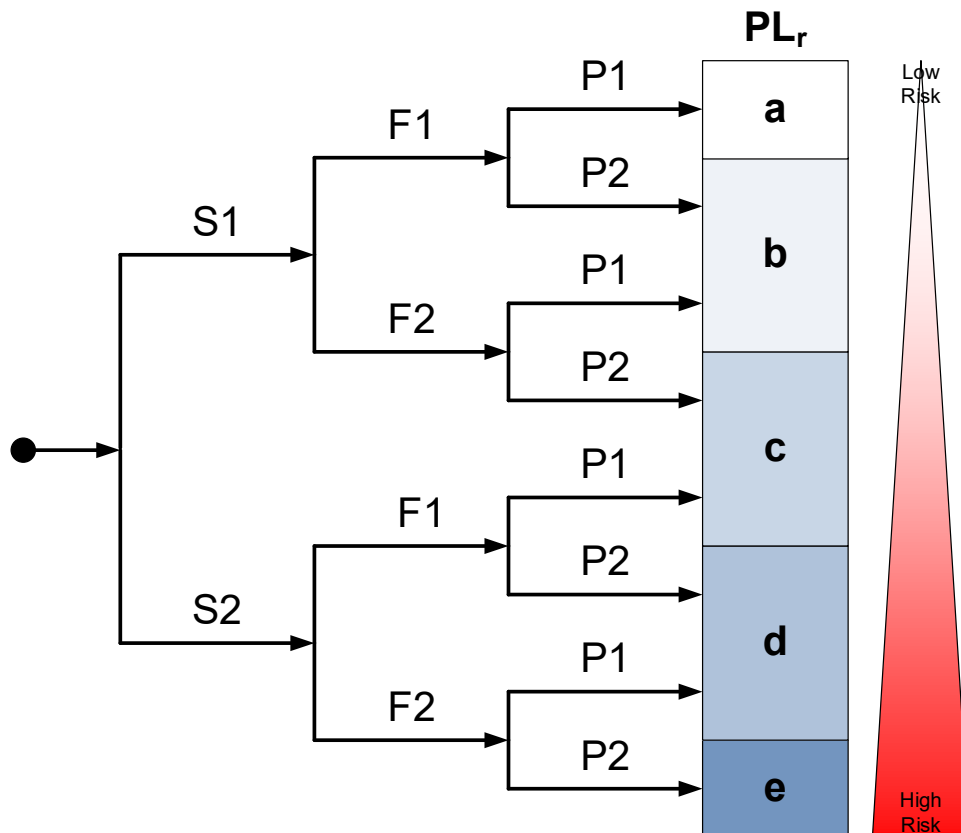

One possibility (of approx. 100): Risk graph

- Question: Are reversible or irreversible injuries possible (S1/S2)?**
Limit: min. 1 day incapable of work (doctor required)
- Question: Is hazard seldom / less frequent and short or often and long (F1/F2)?**
Limit (sector dependent), e.g. access with 10 min. in a shift (8 h) is less frequent and short.
- Question: Avoiding or reduction possible (P1/P2)?**
Limit: During direct access in hazard area is it not possible to avoid the hazard, e.g. at a press.

Generally are risk reduction measures starting with PL_r=c necessary.

Non-quantifiable Aspect: Behaviour under Fault Conditions

- The structure essentially determines the behavior of a safety function in the event of an error.
- **Category 1: 1-channel system**
The occurrence of a fault can lead to the loss of the safety function.
- **Category 2: 1-channel system with monitoring**
The occurrence of a fault between the tests can lead to the loss of the safety function. The test detects the loss of the safety function.

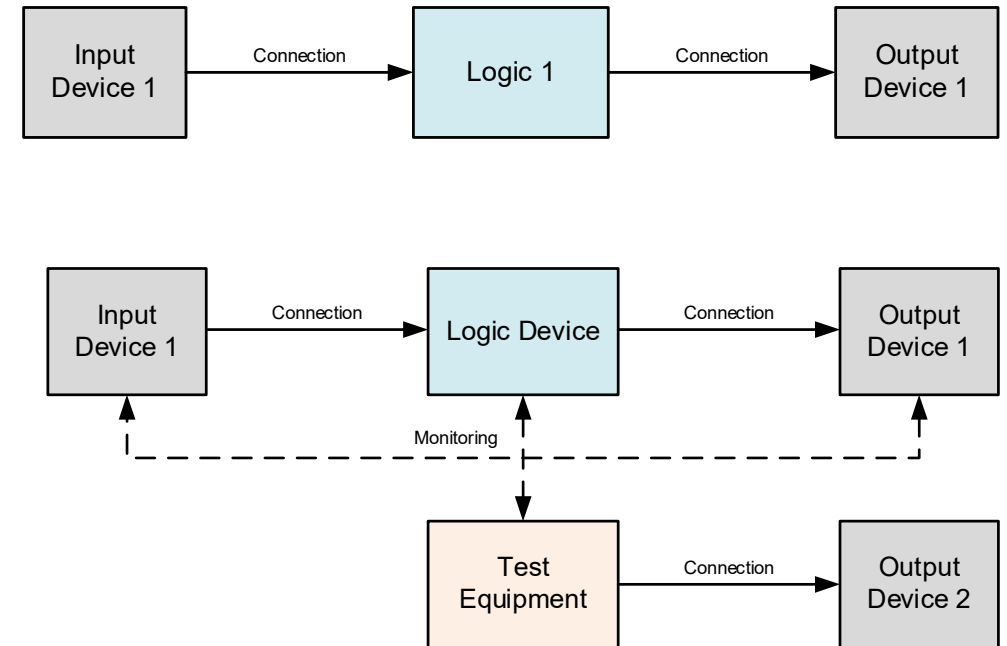





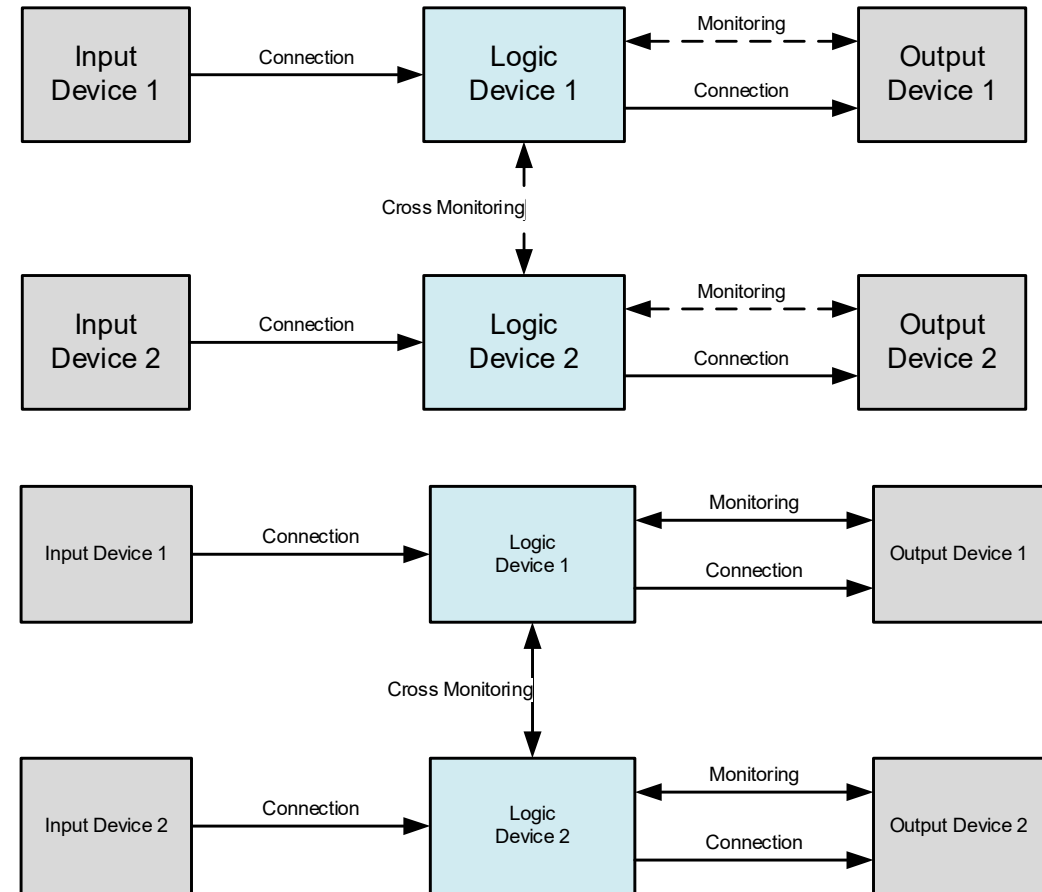

Non-quantifiable Aspect: Behaviour under Fault Conditions



- **Category 3: 2-channel system with monitoring**
An fault is detected in time to prevent loss of the safety function.
- **Category 4: 2-channel system with monitoring**
 - An error is detected in time to prevent loss of the safety function.
 - Accumulation of undetected errors are considered.

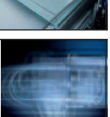

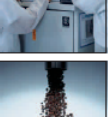
Classified air quality from Festo

Compressed air production	Pneumatic distribution	Air preparation	Class ⁰⁾	Typical applications
Compressor	[--:--:--]	Water separator	[--:7:4]	All applications which require virtually condensate-free compressed air. No defined particle filtering 
Prefilter Air-dryer	[7:4:4] ⁰⁾	40 µm filter	[7:4:4]	Operating medium for valves, cylinders, secondary packaging (standard) 
		5 µm filter	[6:4:4]	Servo pneumatic positioning with proportional directional control valves, pneumatic tools 
		5 µm filter 1 µm filter ^{a)}	[5:4:3]	Applications with a residual oil content ≤0.5 mg/m ³ , textile industry, air-jet spinning machines, paper industry 
		5 µm filter 1 µm filter ^{a)} 0.01 µm filter	[1:4:2]	Applications with a residual oil content of ≤0.01 mg/m ³ , air bearings, painting, powder coating 
		5 µm filter 1 µm filter ^{a)} 0.01 µm filter Activated carbon filter	[1:4:1]	Applications with a residual oil content of ≤0.003mg/m ³ , reduction of oil vapours and odours, optical instruments, sealing air for glass scales/laser, primary packaging 
		5 µm filter 1 µm filter ^{a)} 0.01 µm filter Activated carbon filter Membrane air dryer	[1:3:1]	Semiconductor industry, Pharmaceutical products 
		5 µm filter Adsorption dryer	[2:2:2]	Applications in low temperature ranges, dry process air, powder transport, (food manufacturing: 1:2:1) 
			[7:7:4] ⁰⁾	

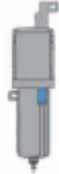

Flow at supply pressure of 10 bar, on units with regulator output pressure of 6 bar in Nl/min

1,000	3,000	5,000	7,000	9,000	11,000	13,000	15,000	17,000	19,000	21,000	23,000	
564858 MS6-LWS-1/2-UV-WB		567857 MS9-LWS-1-UV-WP										
*531029 MSB4-1/4:C4:J1-WP		*531030 MSB6-1/2:C4:J1-WP		*552938 MSB9-1:C2:J73-WP								
*531029 MSB4-1/4:C4:J3-WP		*531030 MSB6-1/2:C4:J3-WP		*552938 MSB9-1:C2:J71-WP								

* The overview only shows a selection of devices and possible combinations.

40 µm and 5 µm filters from Festo have an additional mechanism for separating liquids.

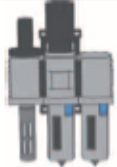
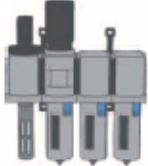
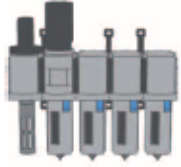
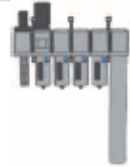
 **Note:** For even higher flows, MS12 series components are available. Ask your sales engineer for the ideal combination.

		200	400	600	800	1,000	2,000	3,000	4,000	5,000	6,000	7,000	8,000	
*531029 MSB4-1/4:C4:j3:l1-WP		*531030 MSB6-1/2:C4:j3:l1-WP			*552938 MSB9-1:C2:j71:l9-WP									
*531029 MSB4-1/4:C4:j3:l1:l3-WP		*531030 MSB6-1/2:C4:j3:l1:l3-WP			*552938 MSB9-1:C2:j71:l9:l12-WP									
*531029 MSB4-1/4:C4:j3:l1:l3:L1-WP		*531030 MSB6-1/2:C4:j3:l1:l3:L4-WP			*552938 MSB9-1:C2:j71:l9:l12:L2-WP									
100	200	300	400	500	600	700	800	900	1,000					
*531029 MSB4-1/4:C4:j3:l1:l3:L1:G7-WP		*531030 MSB6-1/2:C4:j3:l1:l3:L4:G7-WP												
552170 PDAD-09	552171 PDAD-13	552172 PDAD-22	552173 PDAD-51			552174 PDAD-73		552175 PDAD-100			<p>Note: Please order 529607 MS6-LF-1/2-CRM and 532799 MS6-MV in addition to PDAD</p> 			

Pre-Configured Part Numbers Categorized by Air Quality

Ordering data – 3:4:2 complete assemblies

Size	Flow Rate (l/min)	Connection	Part No.	Type
MS4	360	G1/4	8032468	MSB4 3:4:2
MS6	2500	G1/2	8032469	MSB6 3:4:2
MS9	7800	G1	8032467	MSB9 3:4:2

Ordering data – 1:4:2 complete assemblies

Size	Flow Rate (l/min)	Connection	Part No.	Type
MS4	360	G1/4	8031370	MSB4 1:4:2
MS6	2500	G1/2	8031373	MSB6 1:4:2
MS9	7800	G1	8031368	MSB9 1:4:2

Ordering data – 1:4:1 complete assemblies

Size	Flow Rate (l/min)	Connection	Part No.	Type
MS4	360	G1/4	8031372	MSB4 1:4:1
MS6	2500	G1/2	8031371	MSB6 1:4:1
MS9	6500	G1	8031374	MSB9 1:4:1

Ordering data – 1:3:1 complete assemblies

Size	Flow Rate (l/min)	Connection	Part No.	Type
MS4	100	G1/4	8031367	MSB4 1:3:1
MS6	400	G1/2	8031369	MSB6 1:3:1

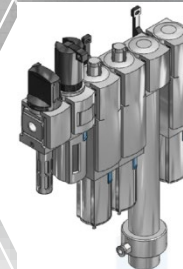
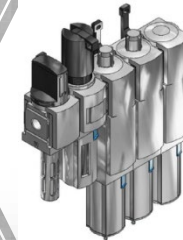
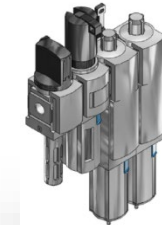
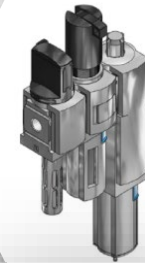

Available
in 1 to 3
days

Stock in
Mason
Ohio

Ordering data: Complete assemblies

Size	Flow rate(l/m)	Connection	Part No.	Type
Ms4	750	NPT 1/4	13095116	MSB4-1/4-3-ASY

ITEM NO.	PartNo	DESCRIPTION	QTY.
1	541259	MS4-EM1-1/4-S - Manual On/off Valve	1
2	535724	MS4-LFR-1/4-D7-EUM-AS - Filter Regulator	1
3	542598	MS4-EE-1/4-10V24-S - Electrical On/off Valve	1
4	526063	MS4-WPB - Mounting Bracket	2
5	151689	KMEB-1-24-5-LED - Socket Connector Cable	1
6	9396	AD-1/4-1/4-NPT-I - Adapter	1
7	538779	MS4-END - Cover Cap	1

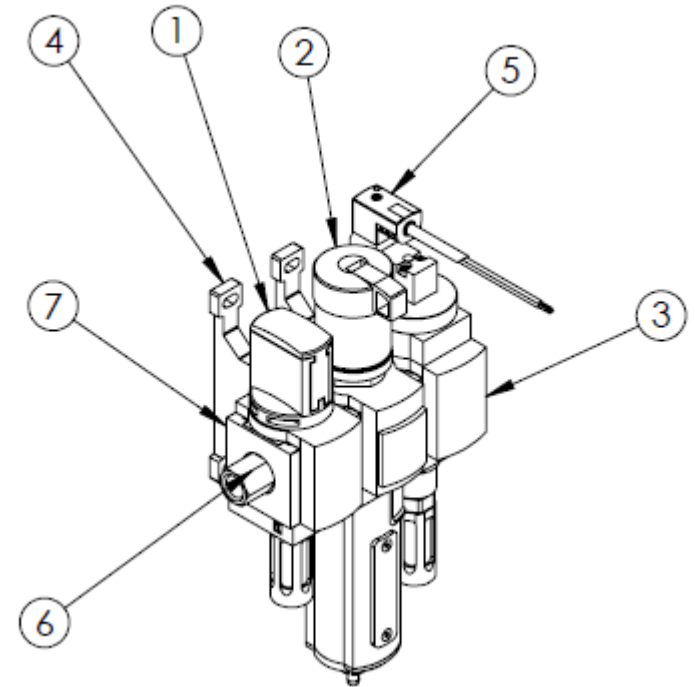

Ordering data: Complete assemblies

Size	Flow rate(l/m)	Connection	Part No.	Type
Ms4	750	NPT 1/4	13095117	MSB4-1/4-5-ASY

ITEM NO.	PartNo	DESCRIPTION	QTY.
1	541259	MS4-EM1-1/4-S - Manual On/off Valve	1
2	535724	MS4-LFR-1/4-D7-EUM-AS - Filter Regulator	1
3	542598	MS4-EE-1/4-10V24-S - Electrical On/off Valve	1
4	526063	MS4-WPB - Mounting Bracket	3
5	532798	MS4-MV - Module Connector	1
6	151689	KMEB-1-24-5-LED - Socket Connector Cable	1
7	9396	AD-1/4-1/4-NPT-I - Adapter	1
8	538779	MS4-END - Cover Cap	1
9	529531	MS4-DL-1/4 - Soft Start Valve	1
10	13122049	MS4-FRM-1/4-AD3 - Branching Module	1
11	541328	NEBU-M12G5-K-5-LE4 - Connection Cable	1
12	3569	B-1/4 - Blanking Plug	2

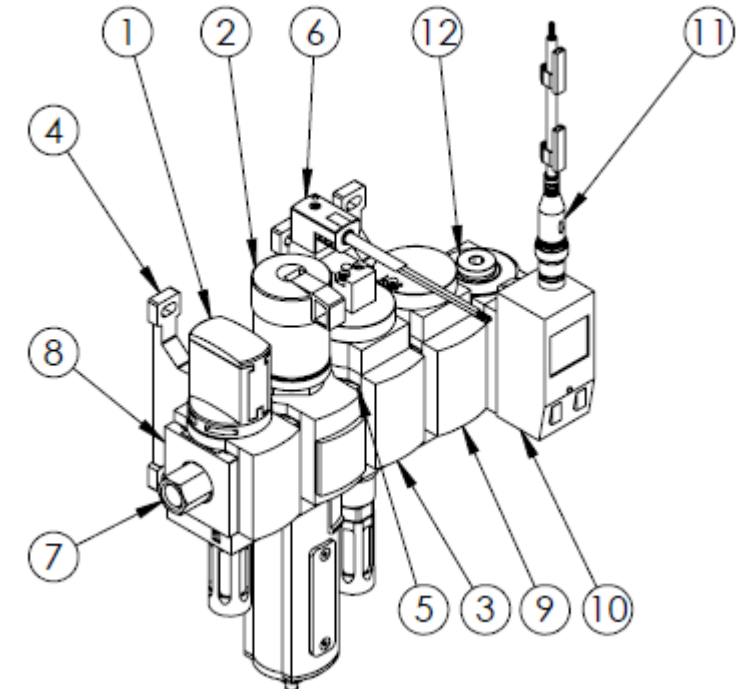

Ordering data: Complete assemblies

Size	Flow rate(l/m)	Connection	Part No.	Type
Ms6	3100	NPT 1/2	13095118	MSB6-1/2-3-ASY

ITEM NO.	PartNo	DESCRIPTION	QTY.
1	541268	MS6-EM1-1/2-S - On/Off Valve	1
2	529192	MS6-LFR-1/2-D7-EUM-AS - Filter Regulator	1
3	542602	MS6-EE-1/2-10V24-S - On/Off Valve	1
4	538780	MS6-END - Cover Cap	1
5	526074	MS6-WPB - MOUNTING BRACKET	2
6	9398	AD-1/2-1/2-NPT-I - Adapter	1
7	151689	KMEB-1-24-5-LED - Socket Connector Cable	1

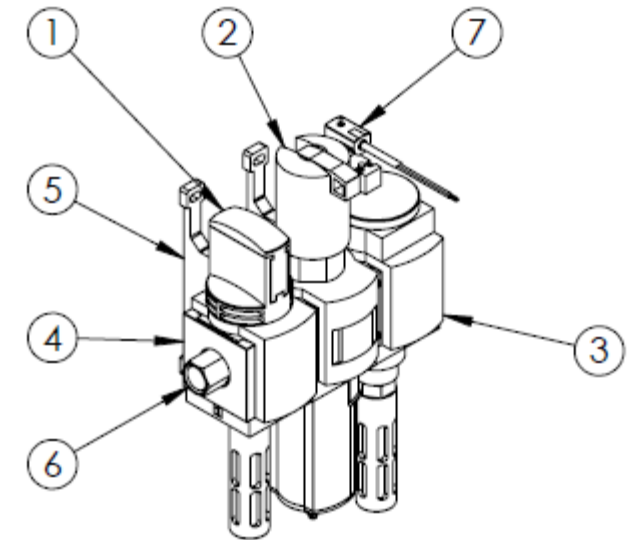

Ordering data: Complete assemblies

Size	Flow rate(l/m)	Connection	Part No.	Type
Ms6	3100	NPT 1/2	13095119	MSB6-1/2-5-ASY

ITEM NO.	PartNo	DESCRIPTION	QTY.
1	541268	MS6-EM1-1/2-S - On/Off Valve	1
2	529192	MS6-LFR-1/2-D7-EUM-AS - Filter Regulator	1
3	542602	MS6-EE-1/2-10V24-S - On/Off Valve	1
4	538780	MS6-END - Cover Cap	1
5	526074	MS6-WPB - MOUNTING BRACKET	3
6	532799	MS6-MV - MODULE CONNECTOR	1
7	9398	AD-1/2-1/2-NPT-I - Adapter	1
8	151689	KMEB-1-24-5-LED - Socket Connector Cable	1
9	529817	MS6-DL-1/2 - Soft Start Valve	1
10	13110201	MS6-FRM-1/2-AD3 - Branching Module	1
11	3571	B-1/2 - Blanking plug	2
12	541328	NEBU-M12G5-K-5-LE4 - Connection Cable	1

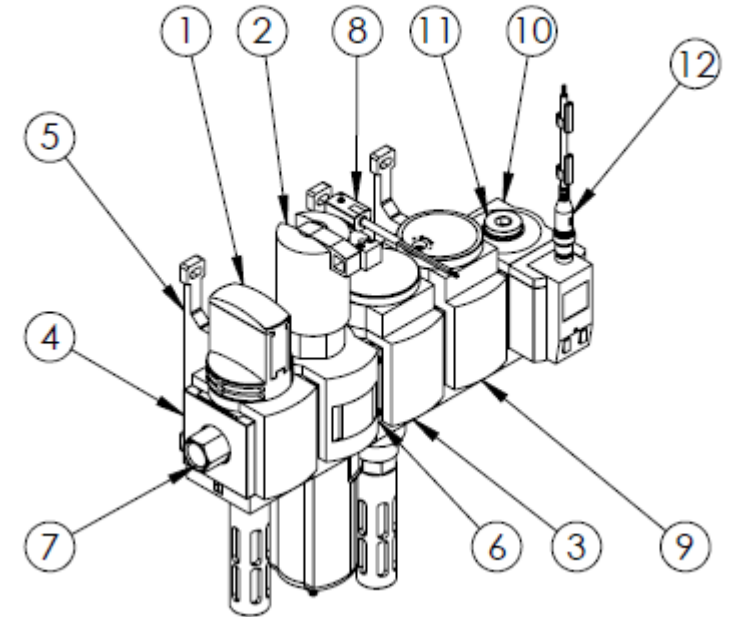

Ordering data: Complete assemblies

Size	Flow rate(l/m)	Connection	Part No.	Type
Ms6	3100	NPT 1/2	CA_CS.2029486	Auto Drain Drip Leg

ITEM NO.	PartNo	Description	QTY.
1	13013303	DNC-100-3/4-SA - DRIP LEG ASY	1
2	3588	D-1/2I-3/4A - Reducing nipple	1
3	531773	OK-3/8 - SEALING RING	1
4	2029486-001	B-3/8-SA - Blanking plug	1
5	152810	WA-2 - Auto Drain	1

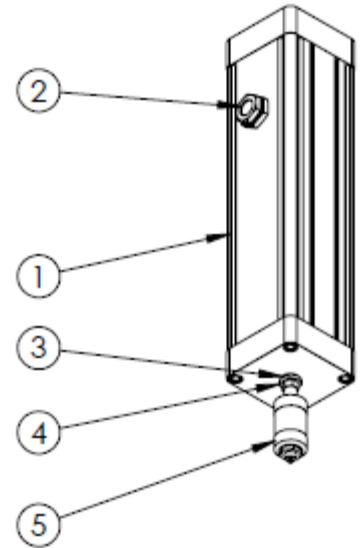

Reference No. CA_CS.2004184

Product	Features	Benefits
<ul style="list-style-type: none"> • Non-interchangeable filters that are in sequence (5 μm, 0.1 μm, 0.01 μm with activated carbon filter– left to right) • NEMA 4X 304 SS enclosure with viewing window 	<ul style="list-style-type: none"> • Back plate painted in bright red for inspection purposes • Pre-configured • One part number • Complies with DIN ISO 8573-1:2010 	<ul style="list-style-type: none"> • Built complete • In stock/ready to ship • Clean air solution • Semi-conductor (clean room) • No risk of contamination

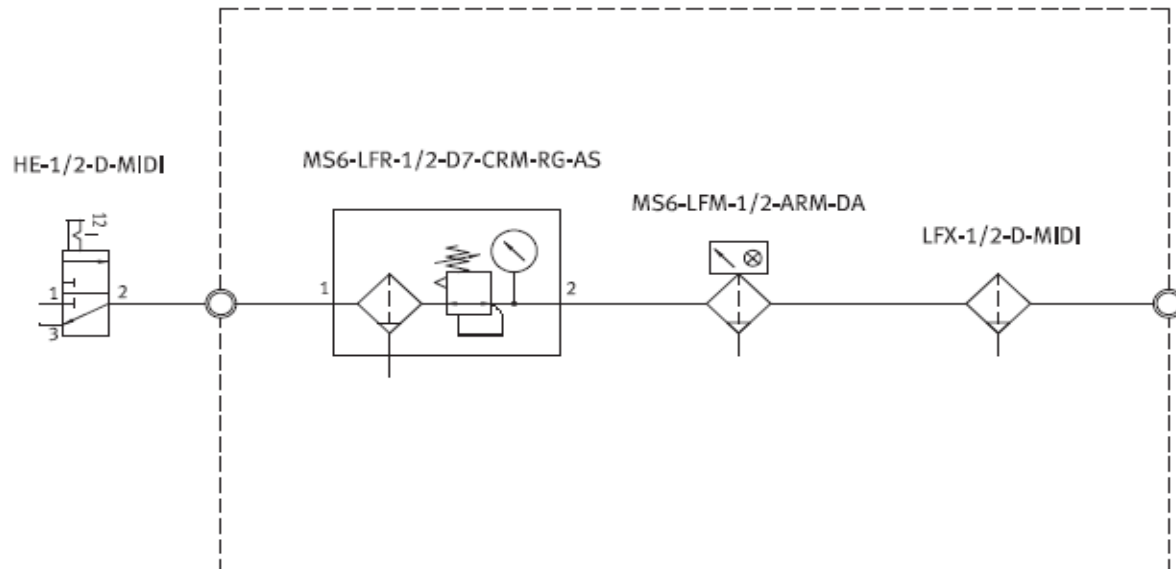

Reference No. 23247488

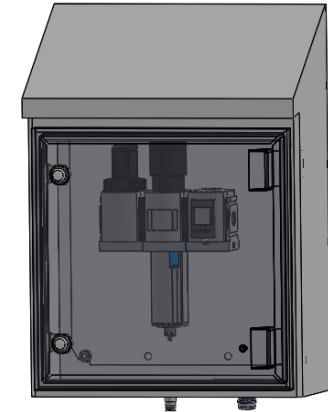
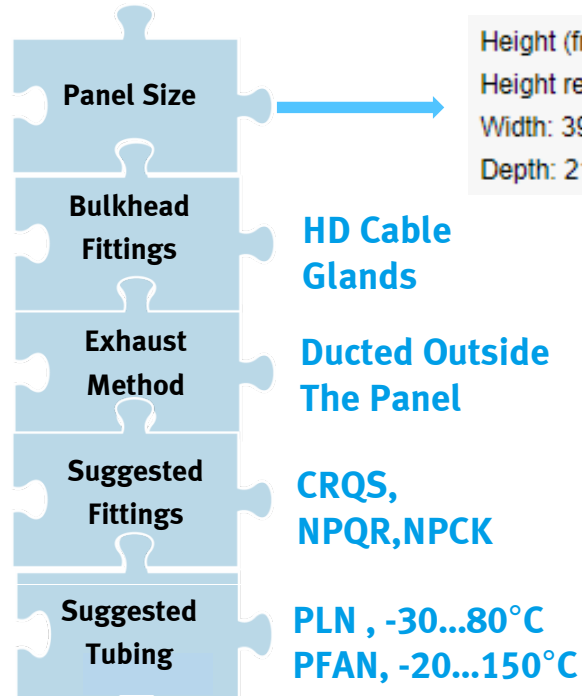
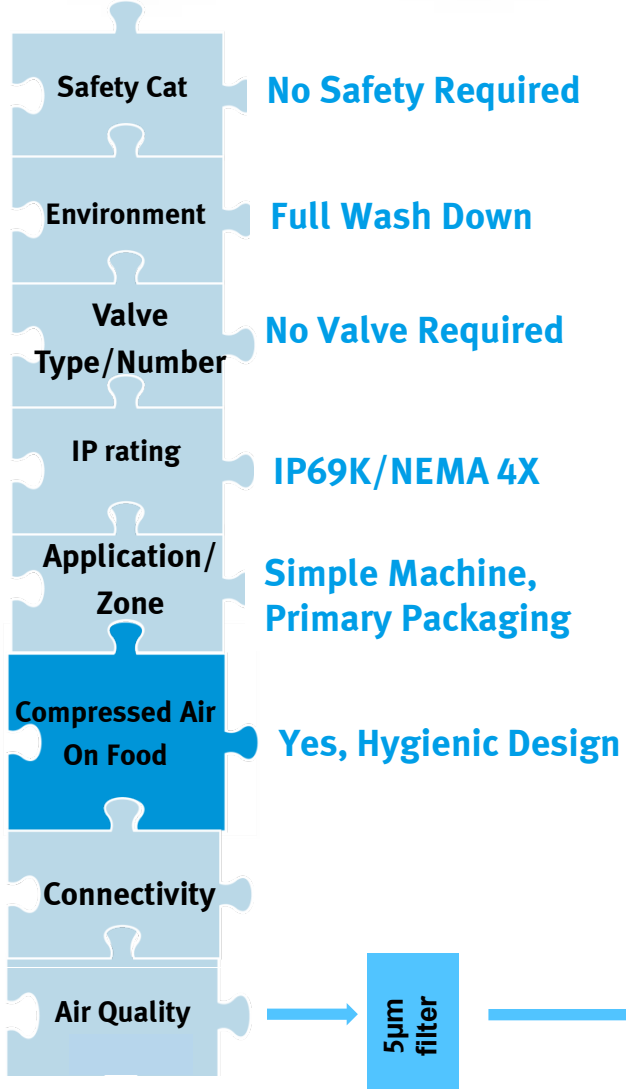

MS6: flow rate 1700...4800 (l/m)
1x Manual On/Off Valve
1x Filter Regulator
1x Branching Module with SPAU sensor

Reference No. 23321264

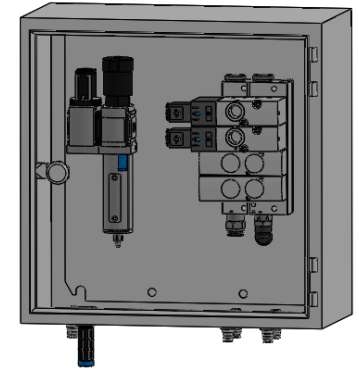
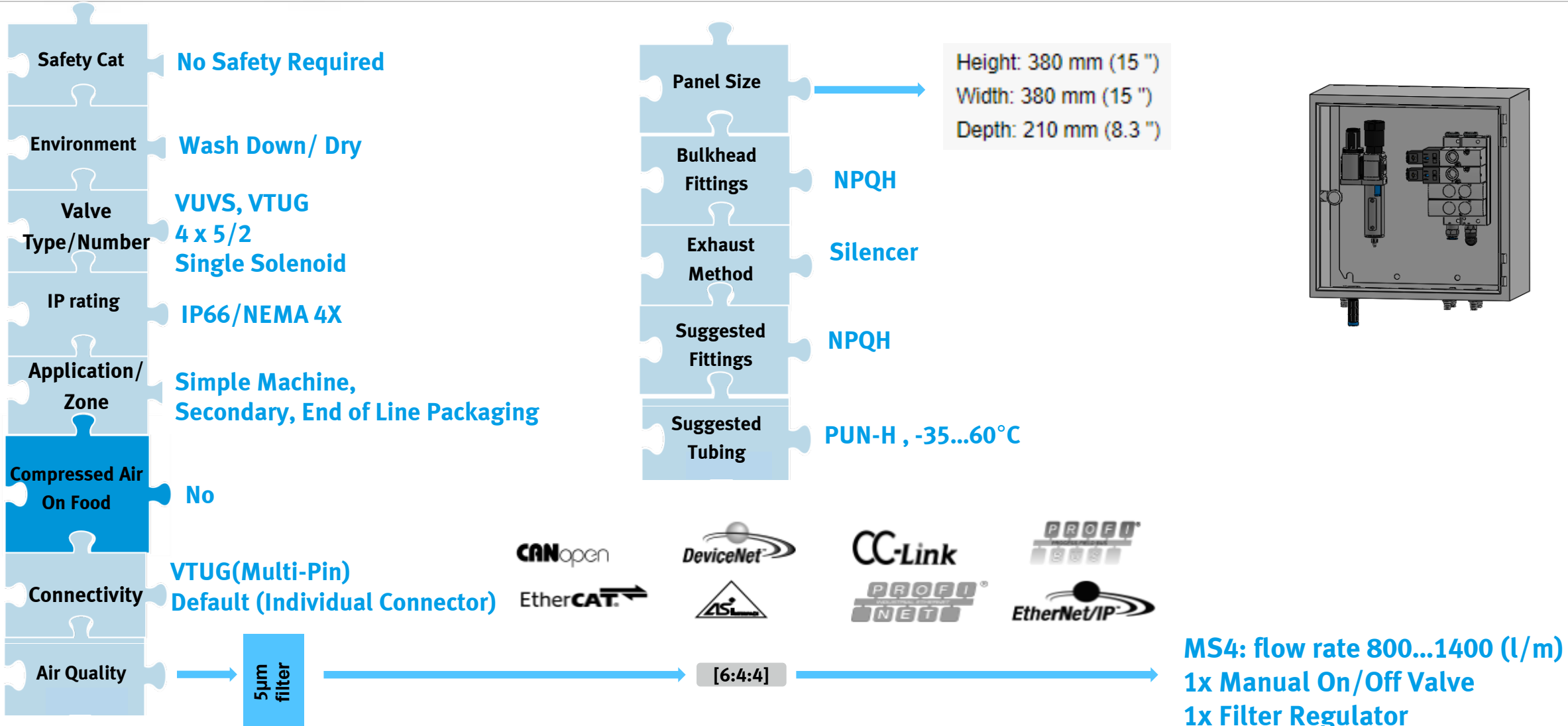

Reference No. 23321266

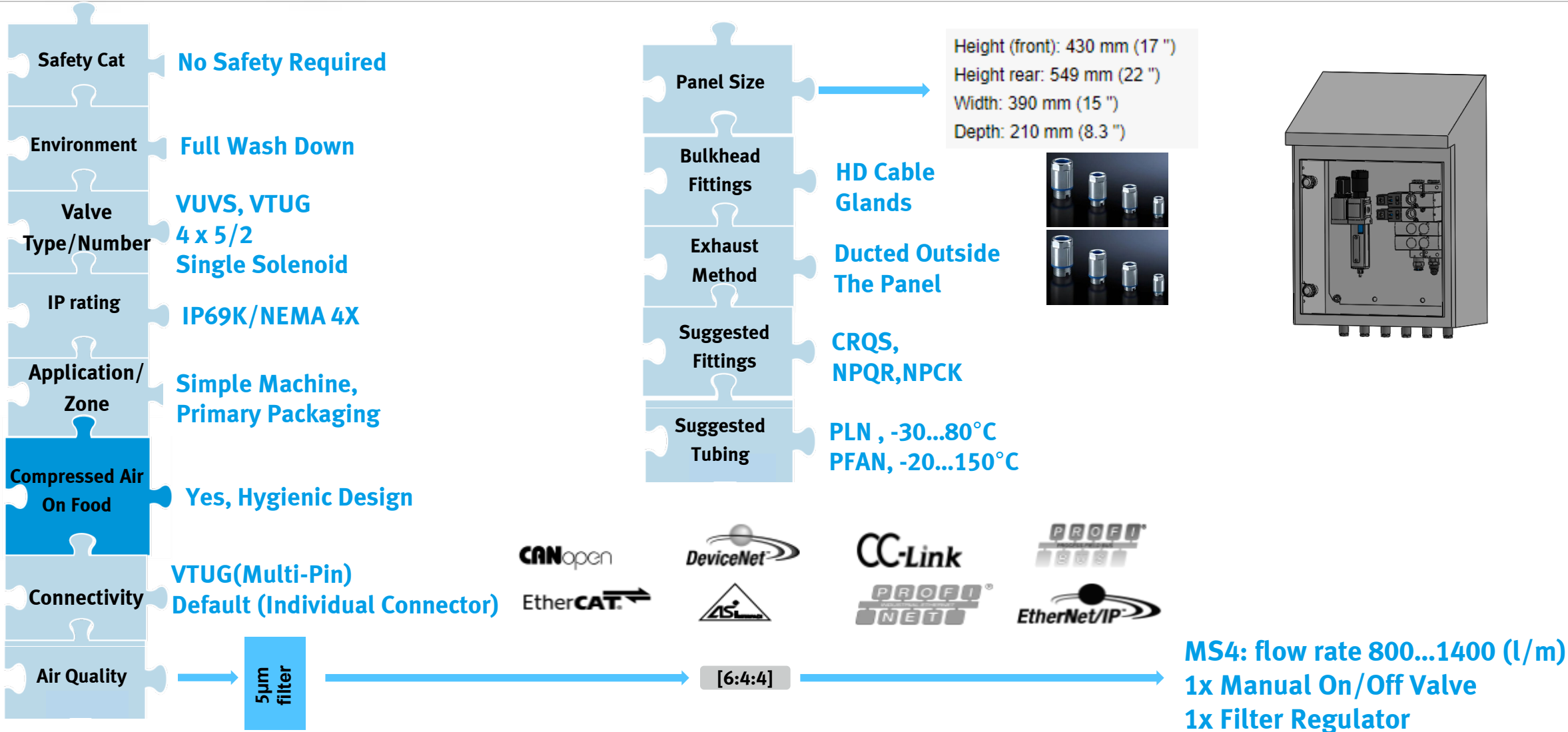

Reference No. 23317005

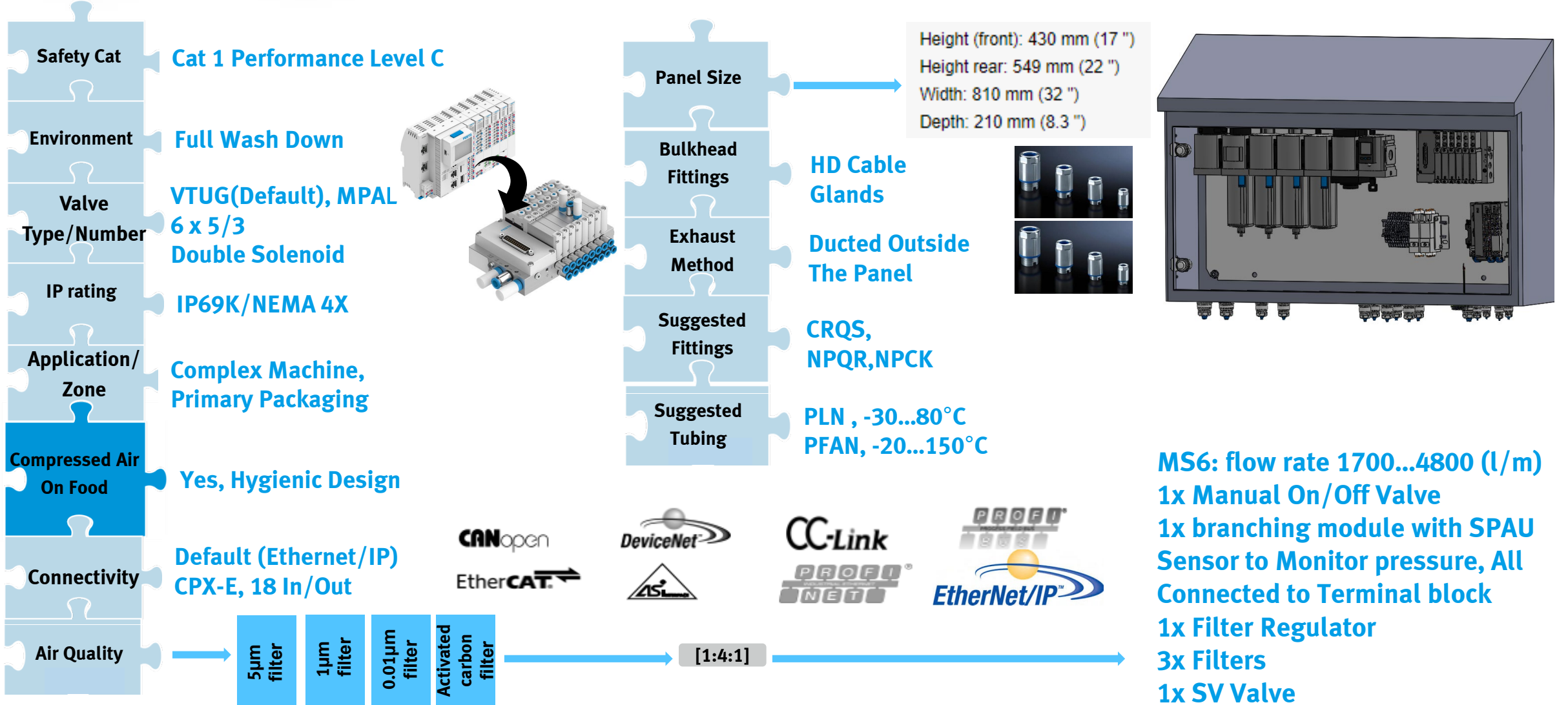

Reference No. 23307522

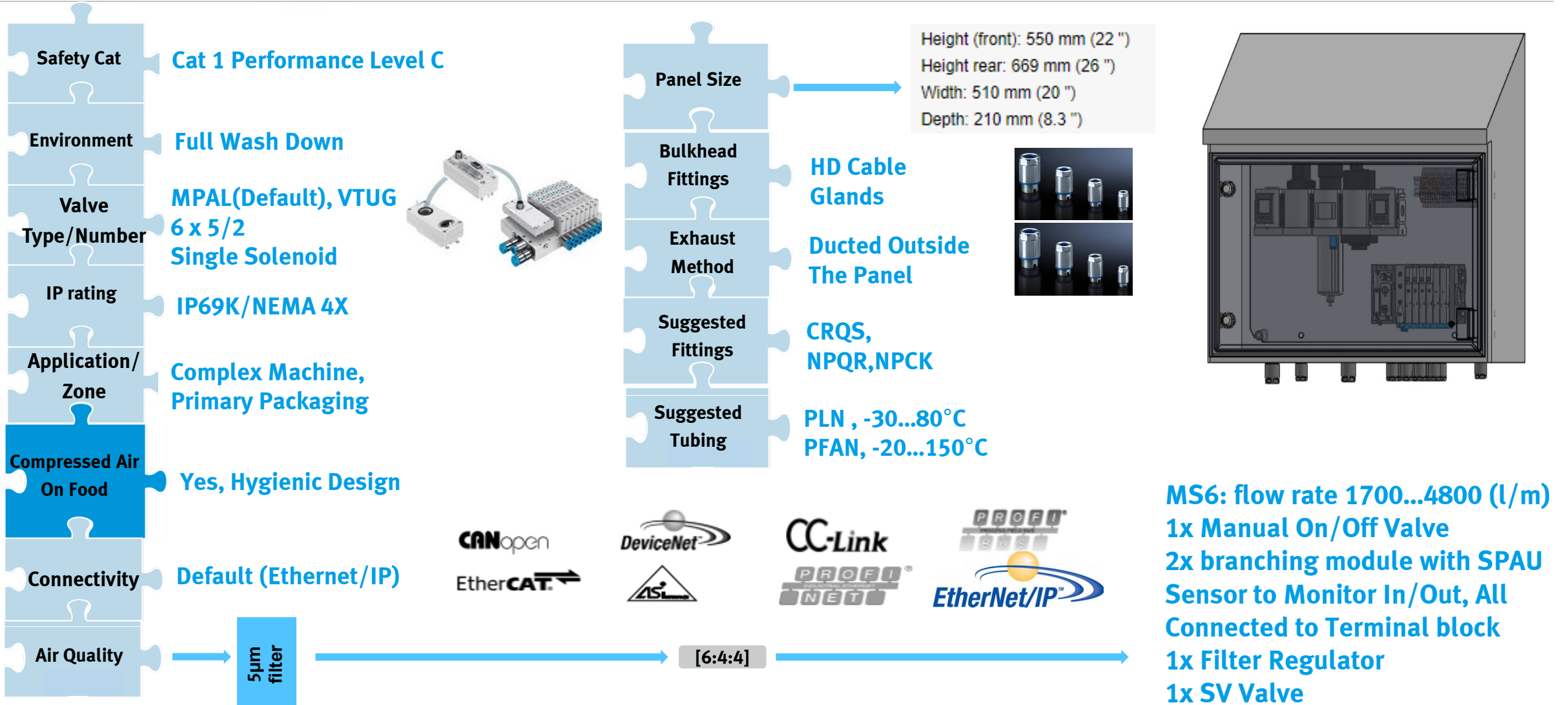

Reference No. 23307525

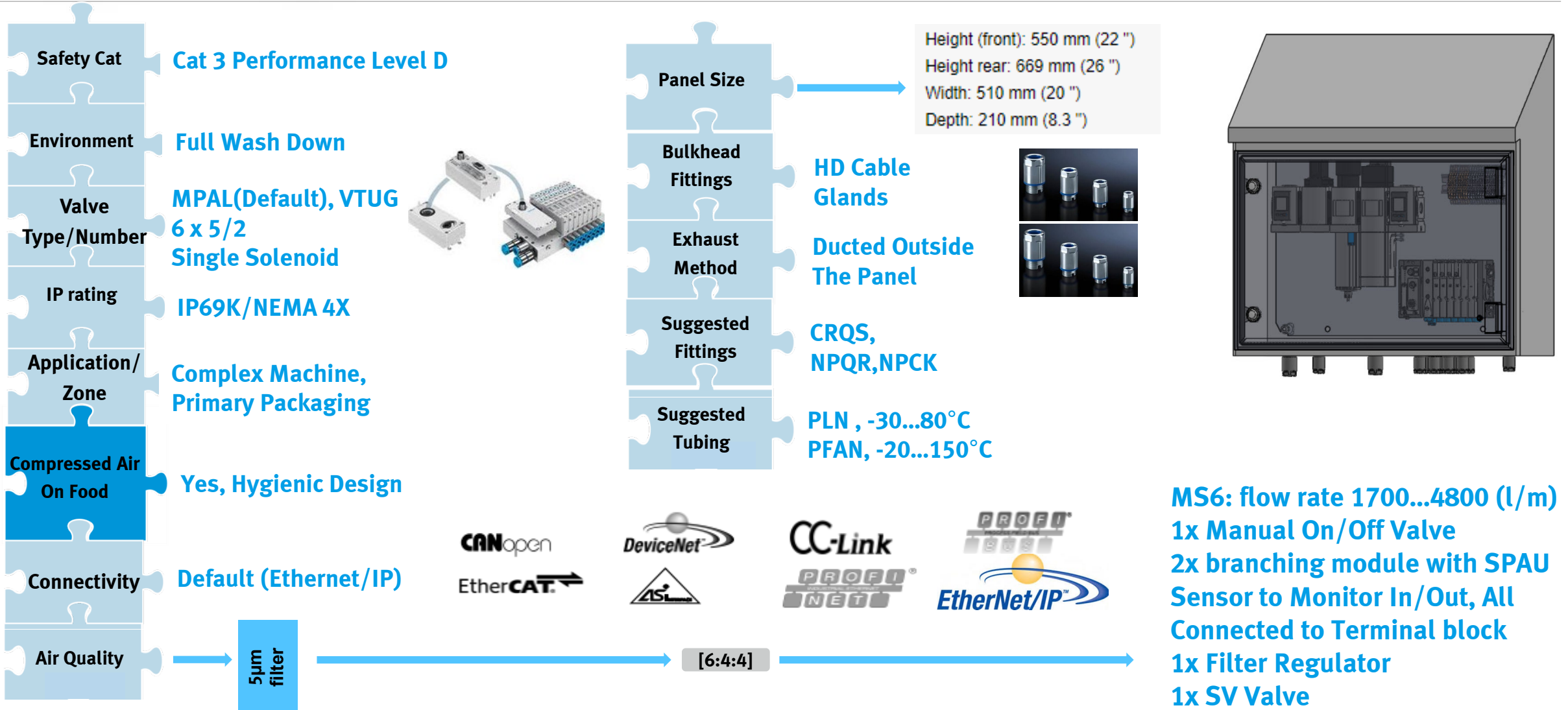

Reference No. 23243756

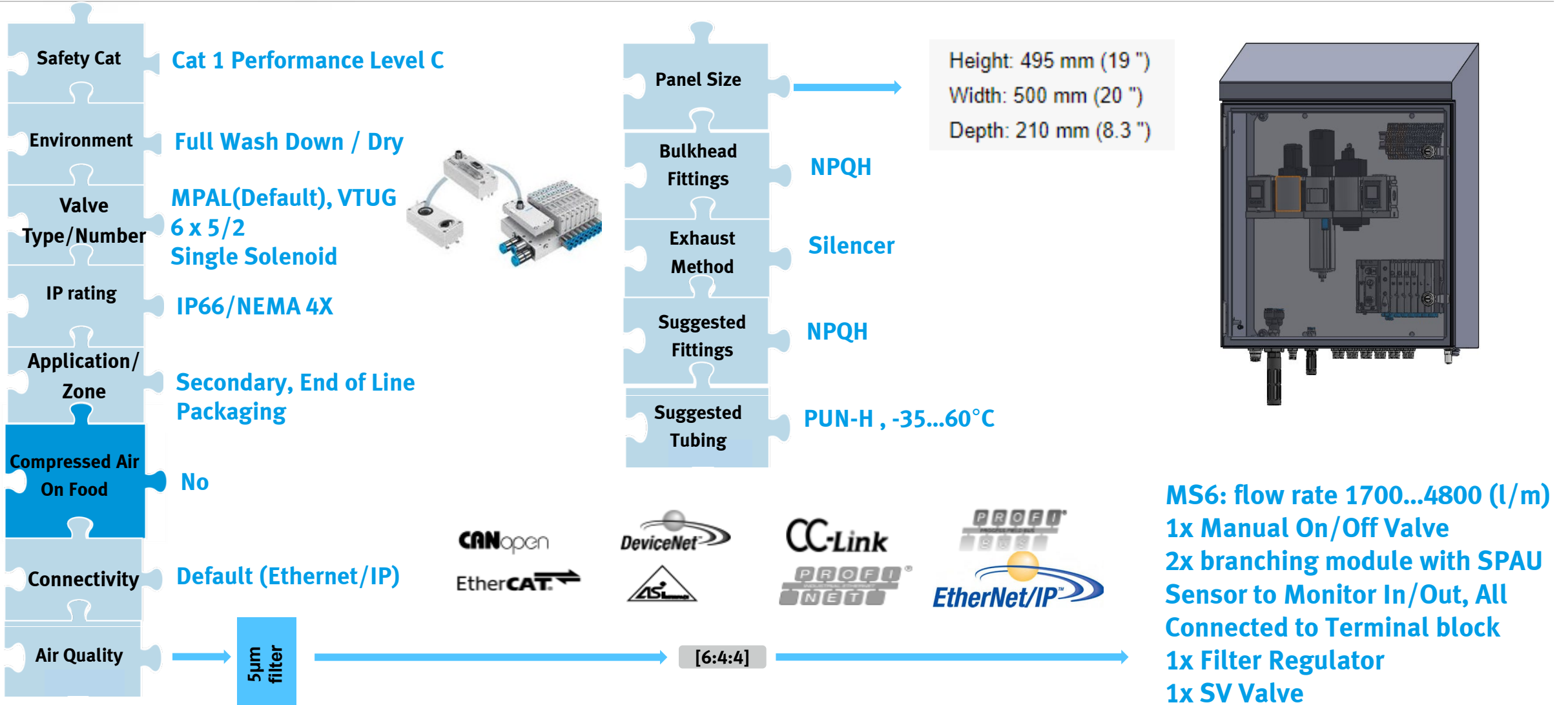

Reference No. 23247489

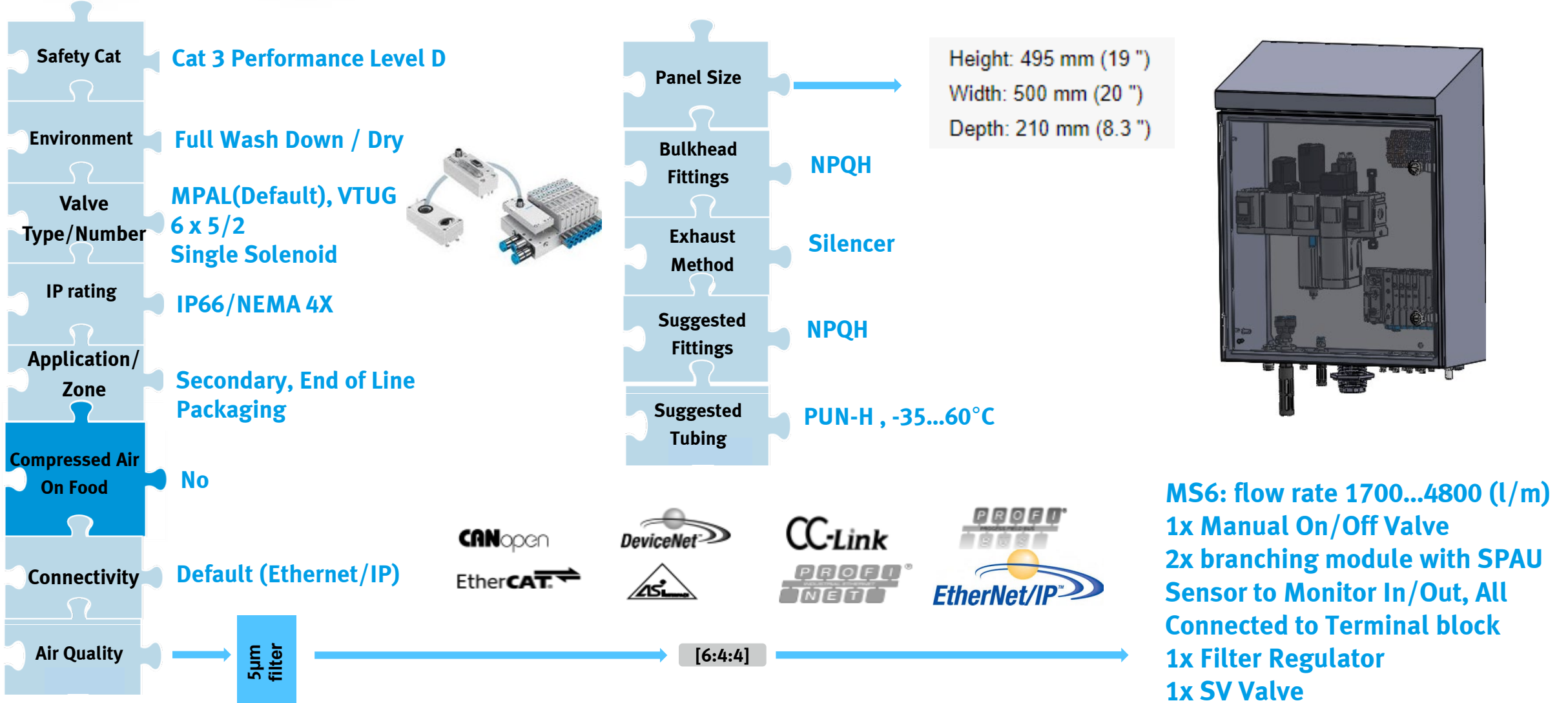

Reference No. 23243758

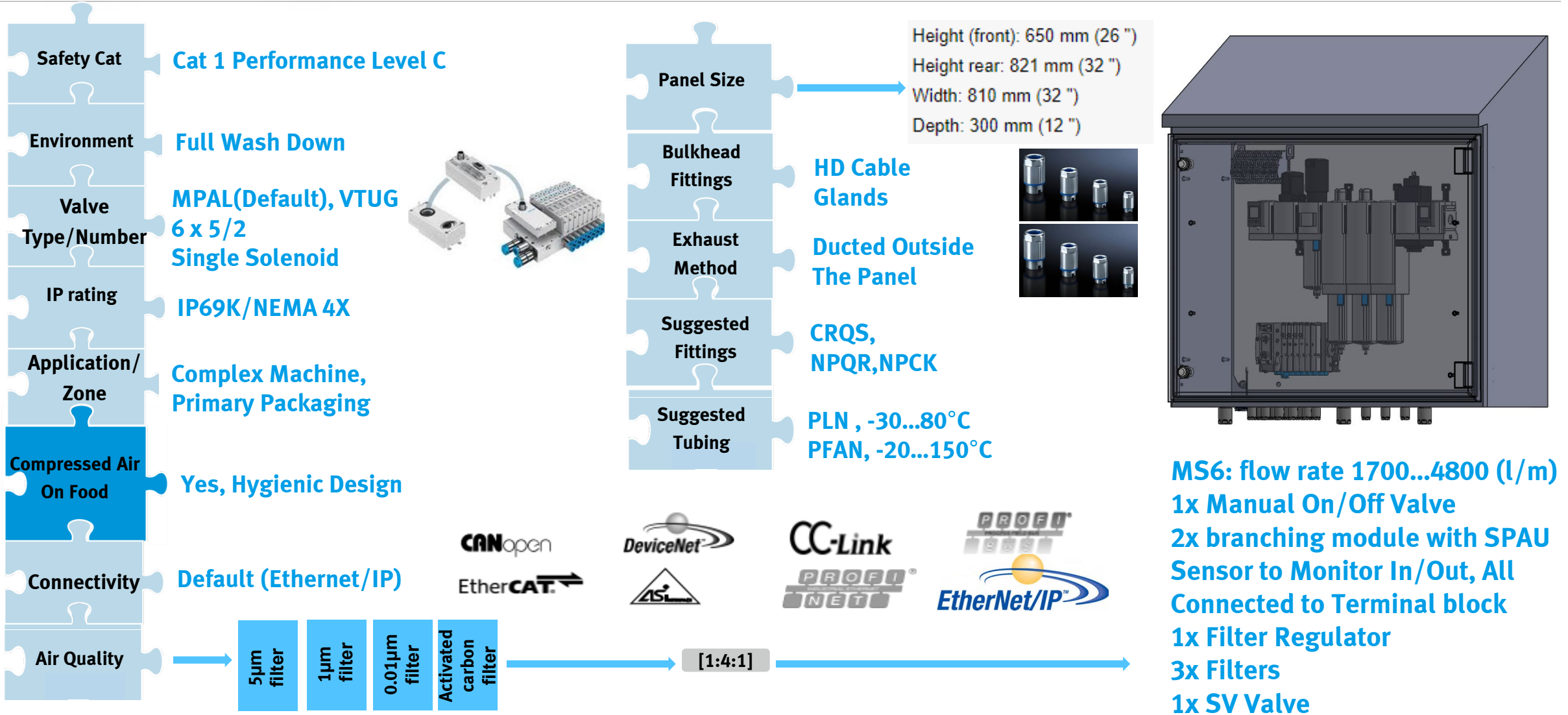

Reference No. 23243761

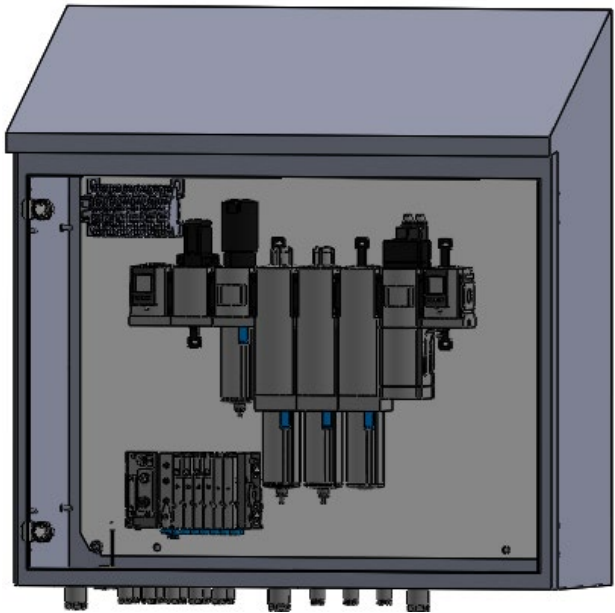
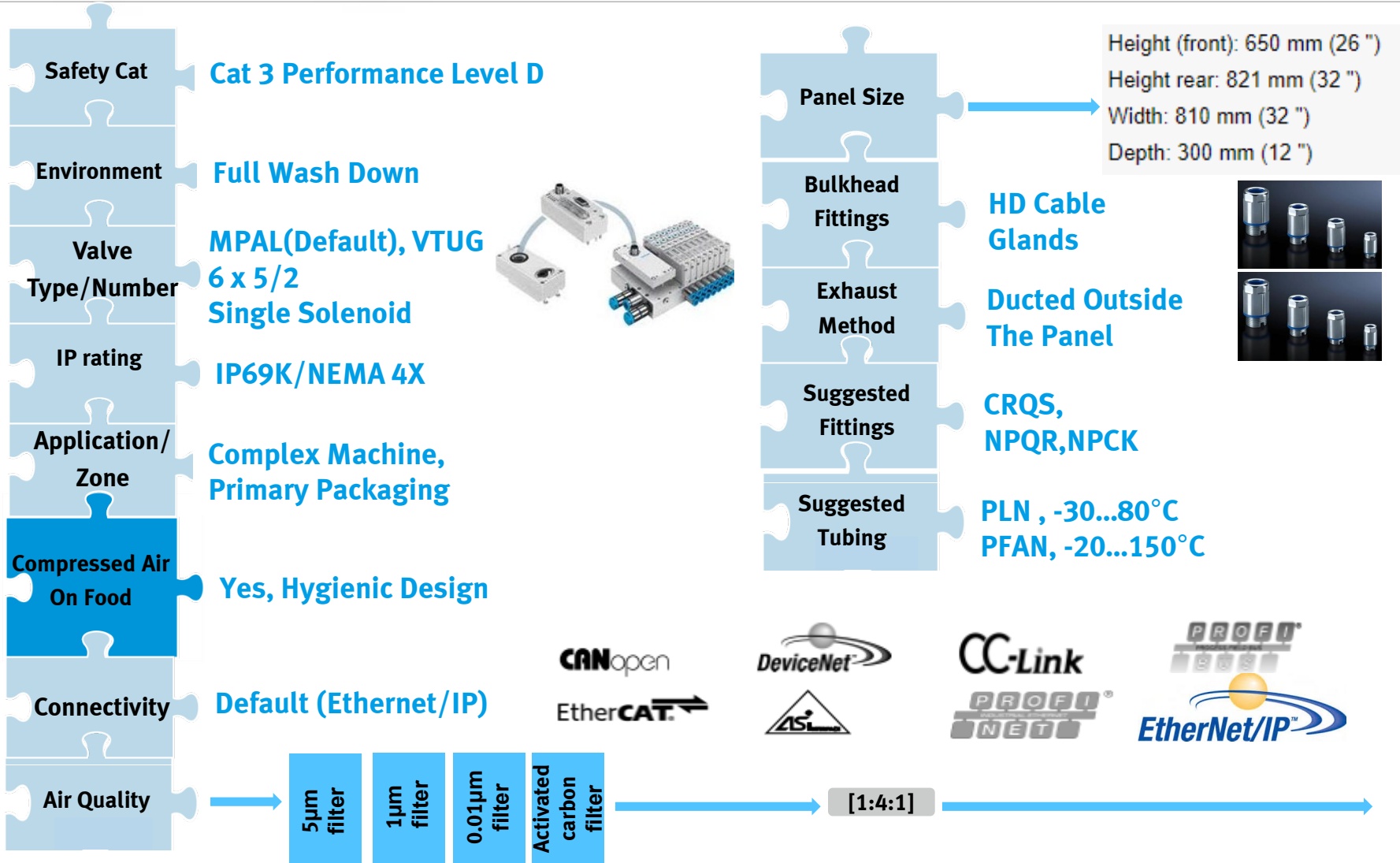

- MS6: flow rate 1700...4800 (l/m)
- 1x Manual On/Off Valve
- 2x branching module with SPAU
- Sensor to Monitor In/Out, All Connected to Terminal block
- 1x Filter Regulator
- 3x Filters
- 1x SV Valve



Check List

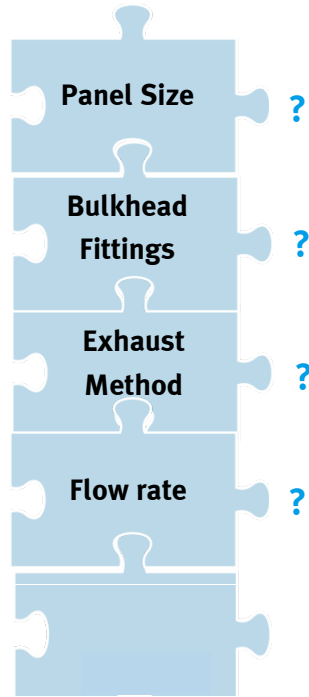
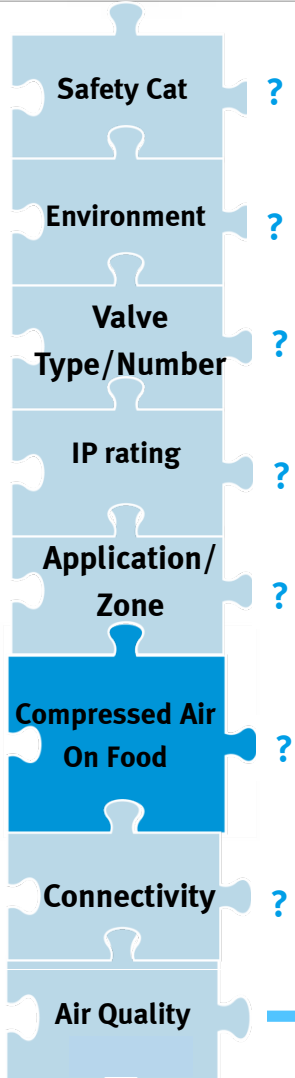

Need your own configuration :
Simply fill out the check list and get your quotation in less than 24h

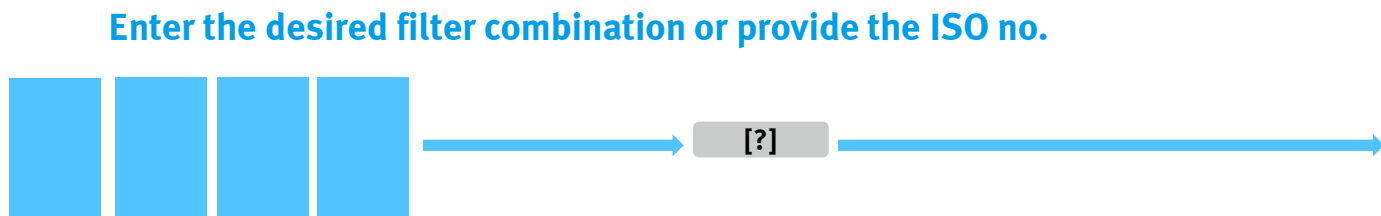

Enter your desired air prep combination

- 1x
- 1x
- 1x
- 1x
- 1x